



## DIN Mud box

### Standards:

- Face to face to DIN87151.
- Inspection to EN12266-1.

### Description:



PART NAME	Litting lug	Cover	Gasket	Body	Screen	Bolts	Drain plug
MATERIAL	Steel	Cast Iron	NBR	Cast Iron	Stainless Steel	Stainless Steel	Brass

DN	L	Dg	Dk	D	f	b	n-d	H1	H2
DN40	200	84	110	150	3	19	4-8	107	113
DN50	230	99	125	165	3	19	4-8	115	123
DN65	290	118	145	185	3	19	4-8	138	132
DN80	310	132	160	200	3	19	8-8	151	140
DN100	350	156	180	220	3	19	8-8	182	150
DN125	400	184	210	250	3	19	8-8	239	160
DN150	480	211	240	285	3	19	8-8	257	185
DN200	600	266	295	340	3	20	8-8	333	227
DN250	600	319	350	395	3	22	12-22	330	284
DN300	600	370	400	445	4	24.5	12-22	350	315
DN350	610	429	460	505	4	24.5	15-22	334	341
DN400	740	480	515	565	4	24.5	15-28	381	376

### Main Features:

#### Advantage:

**Prevent clogging:** By blocking solid particles, it can effectively prevent clogging of the pipeline system and reduce maintenance costs.

**High reliability:** It has stable performance and long service life, and can operate continuously and stably.

Easy maintenance: simple structure, easy to clean and maintain, ensuring long-term and effective use.

**Usage:** DIN straight-through cast iron mud box valves are mainly used in industrial pipeline systems, especially when it is necessary to control impurities and solid particles in the fluid to avoid clogging the pipeline and damaging the equipment. This kind of valve is widely used in pipe networks in industrial fields such as sewage treatment plants, water supply systems, chemical plants, etc. It can effectively maintain the normal operation of the pipeline system and improve the reliability and stability of the system.

QINGDAO I-FLOW CO.,LTD.

Tel: +86 532-66952180    Web: www.iflowmarinevalves.com    E-mail: marinevalves@qdiflow.com



## Air Vent

### Description:

ITEM	PART NAME	MATERIAL
1	BODY	DI/Galv. Steel Q235-B/Alu-bronze/Composite Material
2	BOLT	SUS304
3	FLOAT BALL	PE/SS
4	SIDE COVER	STEEL Q235-B
5	SCREEN	SUS304
6	SEAL	Neoprene
7	SCREWPLUG	PE

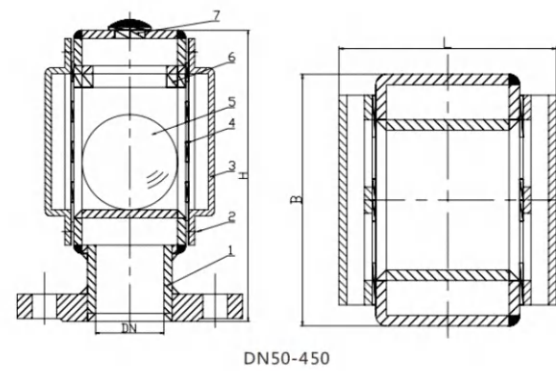

### Main Features:

- The IFLOW Welding Air Tube Head is a cutting-edge solution designed for precision and efficiency in air tube welding applications. It is made using advanced technology and high-quality materials, and has a series of advantages that are different from traditional welding methods. The innovative design of IFLOW welding air tube heads ensures precise and even welding for superior quality and consistency. It delivers accurate and reliable welding performance, reduces the need for rework and increases overall productivity, making it a cost-effective choice for air duct welding projects.

- With its user-friendly interface and intuitive controls, the IFLOW welding air head simplifies the welding process, making operation easier and reducing welder training time. This improves workflow efficiency and increases throughput. The durable construction of IFLOW welded air headers ensures long-term reliability and minimal maintenance requirements, providing a reliable solution for continued use in industrial environments.

- Its rugged design helps minimize downtime and increase uptime, maximizing overall productivity. Rely on IFLOW welding air tube heads for precision, efficiency and reliability in air tube welding applications. Its advanced technology, user-friendly design and cost-effective performance make it ideal for achieving high-quality welds and optimizing workflows in industrial welding operations.

QINGDAO I-FLOW CO.,LTD.

Tel: +86 532-66952180    Web: www.iflowmarinevalves.com    E-mail: marinevalves@qdiflow.com



## DIN Standard Storm Valve

### Standards:

- End Std.: EN 1092/A(DIN 2501).
- Flanges drilled : PN10(DN50-DN250).
- Manufactured in accordance to JIS F 7400.
- Face to Face Std.: DIN HNA Sr 6.
- Pressure rating : PN4(DN50-DN250).
- Flanges as per JIS B 2220 – 5K, 10K.

### Main Features:

No.	Part Name	Material
1	Body	Nodular Cast Iron
2	Bonnet	Nodular Cast Iron
3	Disc with Sealing	Bronze+NBR
4	Bonnet Gasket	NBR
5	Stem	Brass
6	Stem Nut	Brass
7	Handwheel	Cast Iron
8	Plug	Brass
9	Stud Bolts	Steel
10	Nut	Steel

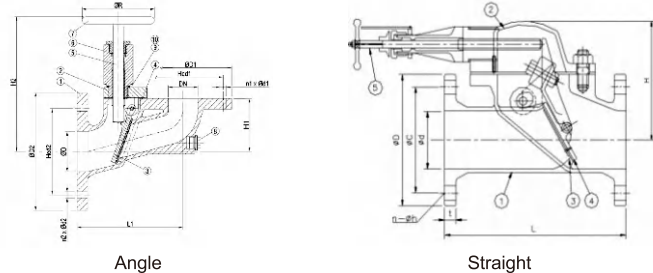

DN	n1xΦd1	Hcd1	ΦD1	n2xΦd2	Hcd2	ΦD2	ΦD	L1	H1	H2	ΦR	Kg
50	4x18	125	165	8x18	160	200	70	180	90	260	140	12
65	4x18	145	185	8x18	180	220	85	200	100	270	140	14
80	8x18	160	200	8x18	210	250	100	215	108	290	140	20
100	8x18	180	220	8x22	240	285	130	250	130	305	140	25
125	8x18	210	250	8x22	270	315	158	290	152	330	160	36
150	8x22	240	285	8x22	295	340	190	330	176	260	160	43
200	8x22	295	340	12x22	350	395	240	425	180	350	160	72

### Description:

Storm valve is a flap type non-return valve which is used to discharge the sewage overboard. It is connected to the soil pipe at one end and other end is at ships side so that sewage gets overboard. So it can be overhauled only during drydocks.

Inside the valve flap is there which is attached to a counter weight, and a locking block. The locking block is the piece of the valve that is controlled and operated by the external hand wheel or actuator. The purpose of the locking block is to hold the flap in place which ultimately prevents the flow of fluid.

Once flow begins, the operator must choose whether to open the locking block, or keep it closed. If the locking block is closed, the fluid will stay out of the valve. If the locking block is opened by the operator, fluid can flow freely through the flap. The pressure of the fluid will release the flap, allowing it to travel through the outlet in one direction. When flow stops, the flap will automatically return to its closed position.

Regardless of whether or not the locking block is in place, if flow comes through the outlet, the back flow will not be able to enter the valve due to the counterweight. This feature is identical to that of a check valve where back flow is prevented so that it will not contaminate the system. When the handle is lowered, the locking block will again secure the flap in its close position. The secured flap isolates the pipe for maintenance if necessary.

### Applications:

Temperature Range — -10°C to +60°C.

QINGDAO I-FLOW CO.,LTD.

Tel: +86 532-66952180    Web: www.iflowmarinevalves.com    E-mail: marinevalves@qdiflow.com



## Quick Closing Valve

This kind of valve is used as emergency cut-off valve, it could be operated manually or by pneumatic actuator or by hydraulic actuator.

### Standards:

- High tightness (leak proofness class – A acc. to EN – 12266 – 1).
- Tests acc. to EN – 12266 – 1.
- Flanges drilled according to EN 1092-1/2 .
- Face-to-face dimension according to EN 558 series 1.
- ISO 15848-1 Class AH – TA-LUFT.

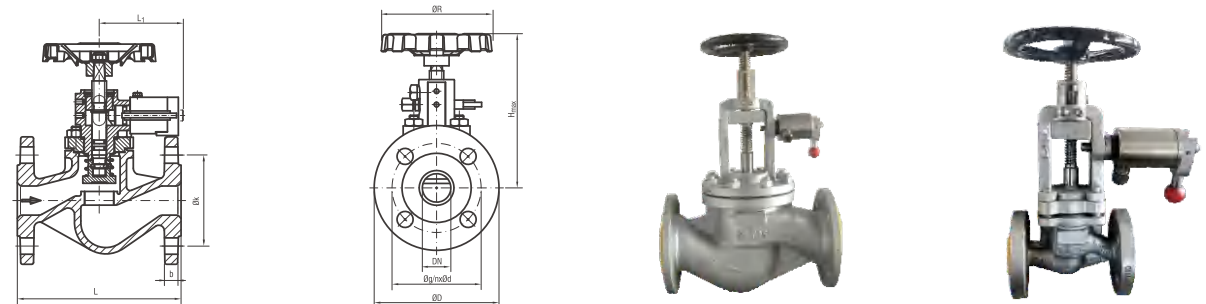

DN	ØD	ØK	Øg	L	b	ØR	H max.	L1	STROK	OTB.
15	95	65	45	130	14	110	160	164	9	4x14
20	105	75	58	150	16	110	160	164	9	4x14
25	115	85	68	160	16	110	165	164	12	4x14
32	140	100	78	180	18	140	170	164	13	4x18
40	150	110	88	200	18	140	185	164	15	4x18
50	165	125	102	230	20	160	190	167	20	4x18
65	185	145	122	290	20	160	205	167	22	4x18
80	200	160	138	310	22	200	250	167	25	8x18
100	220	180	158	350	24	220	270	167	28	8x18
125	250	210	188	400	26	220	310	170	30	8x18
150	285	240	212	480	26	220	370	170	35	8x22

### Main Features:

**Quick closing function:** It can be closed in a very short time, reducing the risk of fluid leakage.

**Operate:** It could be operated by pneumatic actuator or hydraulic actuator or manually.

**Suitable for high pressure:** This type of valve is usually designed for high-pressure environments.

**Simple and reliable structure:** Its structure is usually relatively simple, easy to maintain and operate.

**Good sealing performance:** It can achieve good sealing effect and prevent fluid leakage.

**Both ductile iron and cast steel body materials available.**

### Applications:

Pipes: Hot oil system  
Steam system  
Hot and cold water system

Industries: Shipbuilding industry  
Chemical industry  
Heating

QINGDAO I-FLOW CO.,LTD.

Tel: +86 532-66952180    Web: www.iflowmarinevalves.com    E-mail: marinevalves@qdiflow.com

# MARINE VALVE

WITH CARING SERVICE



QINGDAO I-FLOW CO.,LTD.

TEL: +86 532-66952180

WEB: WWW.IFLOWMARINEVALVES.COM

E-MAIL: MARINEVALVES@QDIFLOW.COM

## ◆ Concentric Type Butterfly Valve

### Description:

- End connection includes wafer, lug, semi-lug, double flanged, mono flanged, grooved.
- Body Materials available in cast iron, cast steel, stainless steel, bronze.
- Working pressure 10bar/16bar.
- Medium: Water, oil, gas, and so on.
- Working temperature: -20°C~180°C.



Material List		
No.	Part	Material
1	Body	Cast iron GJL-250 Nodular iron GJS-400-15 / Nodular iron GJS-500-7 Stainless steel AISI 304 / Stainless steel AISI 316 Cast carbon steel / Aluminium
2	Disc	Nodular iron GJS-400-15 / Nodular iron GJS-500-7 Stainless steel AISI 304 / AISI 316 / AISI 316L Cast carbon steel / Aluminium bronze Hastelloy / Duplex stainless steel
3	Shaft	Stainless steel AISI 420 / AISI 304 / AISI 316 Stainless steel AISI 316L / AISI 431 Hastelloy / Duplex stainless steel / Monel
4	Seat	EPDM / Nitrile(Buna N) / PTFE / VITON High temperature EPDM / Hypalon Silicone / Natural rubber(NR)
5&6&7&8&9	Bushing	PTFE
10&11	O Ring	Rubber
12	Retaining Plate	Stainless Steel/Other Alloys
13	Retaining Plate Screw	Stainless Steel

### Main Features:

- Small in size and light in weight, easy to install.
- Simple, compact structure, quick 90-degree on/off operation.
- Can be used in cutting off and regulating medium.
- Long service time, standing the test of 10000 times opening/closing operation.
- Surface coating: Epoxy powder coating is adopted, with strong adhesion and good weather resistance. It can be used indoors and outdoors.
- Both options of replaceable seat and vulcanization seat.
- Corrosion resistant type with PTFE lined disc is available.
- IACS Class Foundry Approval Available for all butterfly valves.

### Standard:

- Design standard: BS5155, API 609, EN593.
- Test standard: DIN 3230 part 3, API 598, EN12266-1.
- Face to face standard: DIN 3202 K1, API 609, EN558-1, ISO 5752.
- Flange connection: DIN 2501 PN6/10/16, ASME B16.1 125LB and 150LB, JIS B2220 5K/10K/16K.

### Application:

Maritime	Electric power
Municipal construction	Water supply and drainage
Water conservancy projects	Water treatment

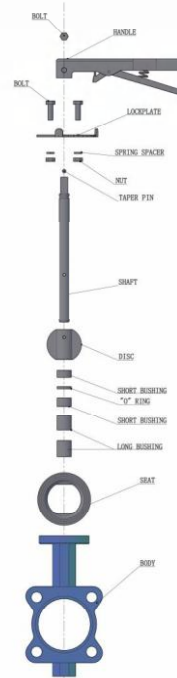

## ◆ DIN Globe/SDNR Valve - ON&OFF/Regulating disc/with Bellow

### Standards:

- High tightness (leakproofness class – A acc. to EN – 12266 – 1).
- Tests acc. to EN – 12266 – 1.
- Flanges drilled according to EN 1092-1/2.
- Face-to-face dimension according to EN 558 series 1.
- ISO 15848-1 Class AH – TA-LUFT.

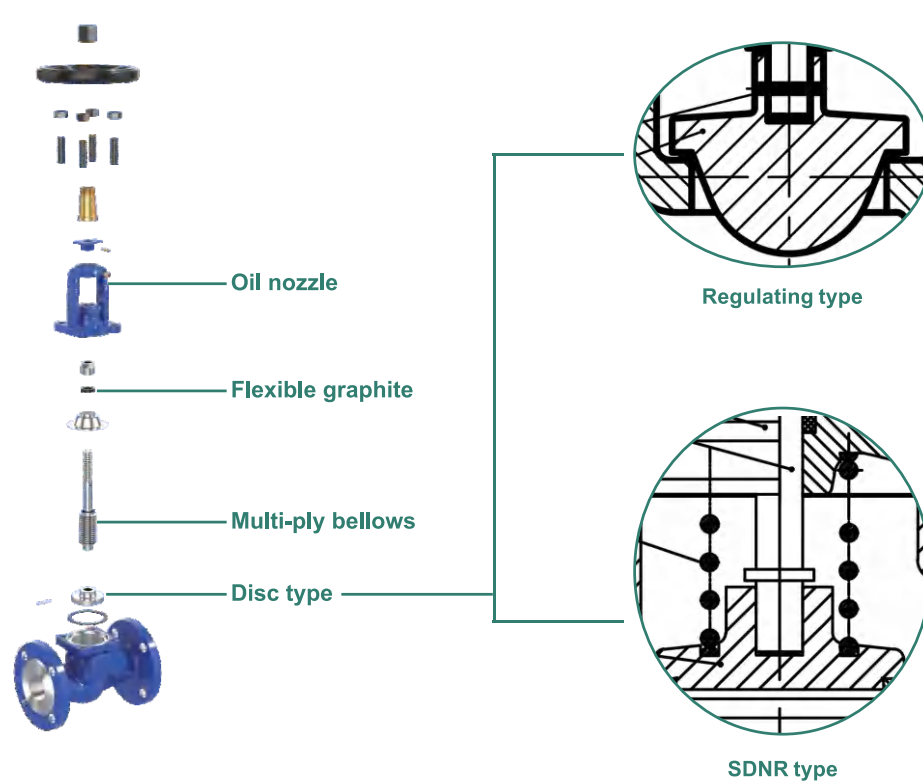

Body material	Nominal pressure	Nominal diameter	Max.temperature
Nodular cast iron	16bar	DN15-350	350°C
Forged steel	40bar 100bar	DN10-50	450°C
Cast steel	16bar 25bar 40bar 64bar 100bar	DN15-DN400	450°C
Cast stainless steel	16bar 25bar 40bar 64bar 100bar	DN15-DN400	450°C
Bronze	16bar 10bar 6bar	DN15-DN125 DN150-DN200 DN250-DN300	225°C

## ◆ DIN Globe/SDNR Valve - ON&OFF/Regulating disc/with Bellow

Body	EN-GJS-400-18-LT 5.3103(ex.JS1025)		CuSn5Zn5Pb5-c CC491K	GP240GH 1.0619	GX5CrNiMo19-11-2 1.4408
Seat ring	X12Cr13 1.4021	CuSn5Zn5Pb5-c CC491K	CuSn5Zn5Pb5-c CC491K	X12Cr13 1.4021	X5CrNiMo17-12-2 1.4401
Bonnet	EN-GJS-400-18-LT 5.3103(ex.JS1025)		CuSn5Zn5Pb5-c CC491K	GP240GH 1.0619	GX5CrNiMo19-11-2 1.4408
Disc	X20Cr13+QT 1.4021 / DIN1693 GGG40	CuSn5Zn5Pb5-c CC491K / DIN1693 GGG40	CuSn5Zn5Pb5-c CC491K	X12Cr13 1.4021	X5CrNiMo17-12-2 1.4401
Stem	X20Cr13 1.4021	DIN 17660 CuZn40Pb2	CuSn35Ni	X20Cr13 1.4021	X5CrNiMo17-12-2 1.4401
Handwheel	DIN 1691 GG25				
Gland packing	Graphite		PTFE	Graphite	Graphite
Gasket	Graphite		Aramid fiber	SS304+GRAPHITE	SS316+GRAPHITE
Max.temperature	350 C	225 C	225 C	400 C	400 C

### Main Features:

- The sealing surface on disc is stainless steel, stellite alloy, babbitt alloy, bronze alloy.
- Disc type: cone type, regulating type, with soft sealing type, balance disc type.
- Bonnet with back seat.
- Packing available in a variety of materials: flexible graphite, PTFE, PPL, fugitive packing.
- Small torque, light switch.
- IACS Class Foundry Approval Available.
- Connection: flanged, welded, threaded.

### Applications:

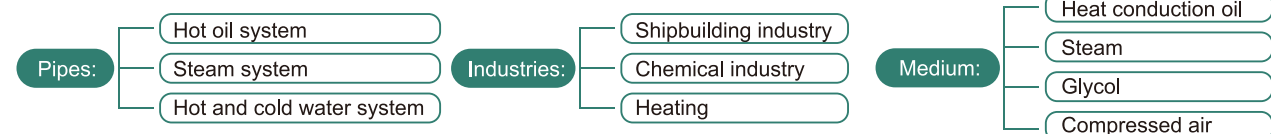

## ◆ DIN F4 Non-Rising Stem Metal Seated Gate Valve

### Standards:

- Design conforms to DIN 1171.
- Face to face dimensions conform to EN558.1 F14.
- Flanges drilled to EN1092-2 PN10/16.
- Test according to EN12266-1 grade C.

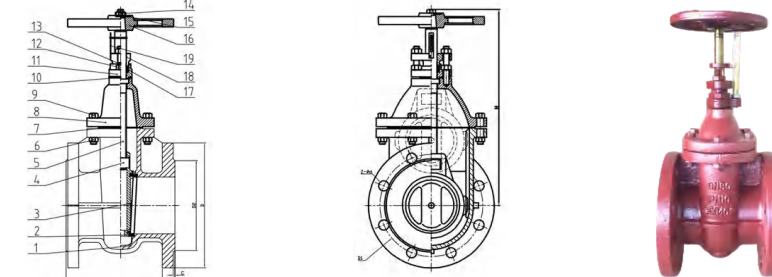

SIZE	L	D	D1	D2	B	C	z-d	H
40	140	150	110	84	16	3	4-19	203
50	150	165	125	99	20	3	4-19	220
65	170	185	145	118	20	3	4-19	245
80	180	200	160	132	22	3	8-19	280
100	190	220	180	156	22	3	8-19	331
125	200	250	210	184	24	3	8-19	396
150	210	285	240	211	24	3	8-19	438
200	230	340	295	268	26	3	12-23	513
250	250	405	355	320	28	3	12-28	612
300	270	460	410	370	28	3	12-28	689

### Main Features:

- IFLow launches the DIN F4 NRS metal seat gate valve with bronze seal, the ultimate solution for seawater applications. Designed with precision and durability in mind, this gate valve combines rugged ductile iron construction with corrosion-resistant bronze seals for unparalleled performance in marine environments.

- Designed to withstand the harsh conditions of seawater systems, this gate valve features a non-rising stem (NRS) design to ensure smooth operation and easy maintenance. The bronze seal further enhances its resistance to corrosion and wear, providing long-term reliability and safety for critical offshore operations. This gate valve is classification society certified for marine applications and meets the highest industry standards, giving you peace of mind and regulatory compliance.

- Clear indicators allow for easy monitoring and operation, making them ideal for fluid control in challenging marine environments. Upgrade your marine fluid control system with the IFLow DIN F4 NRS metal seat gate valve and experience unparalleled performance, longevity and safety in saltwater applications. Trust IFLow's reliable solutions to deliver exceptional durability and reliability in the harshest marine environments.

### Applications:

Suitable media	Water
----------------	-------

## MORE MARITIME PRODUCTS



New Material  
Butterfly Valve(Al.cer.)



Double Eccentric  
Butterfly Valve



Triple Eccentric  
Butterfly Valve



Short pattern swing  
check valve

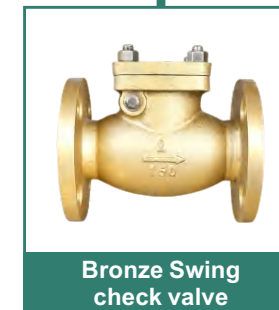

Bronze Swing  
check valve



High Velocity Pressure  
Vacuum Relief Valve



FCU Valve Kit



Stainless  
Steel Valves

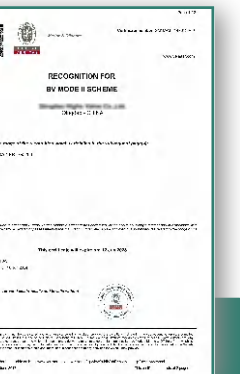
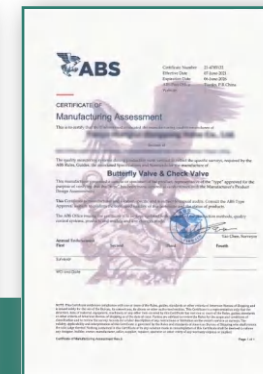

## QINGDAO I-FLOW CO.,LTD.

TEL: +86 532-66952180

WEB: WWW.IFLOWMARINEVALVES.COM

E-MAIL: MARINEVALVES@QDIFLOW.COM

FACTORY: NO.15, JINSHAJIANG ROAD, TONGJI STREET, JIMO DISTRICT, QINGDAO, CHINA

SALES OFFICE: UNIT 1517-1520, BUILDING 4, EXCELLENCE CENTURY CENTER, NO. 31  
LONGCHENG ROAD, QINGDAO, CHINA